



For Sale

225 NE Middlefield Rd, Portland, OR



\$525,000

•Building Square Feet: Approximately 11,880
Office Approximately 2880 SF, Warehouse Approximately 9000 SF

•3 ADA compliant restrooms

•Loading: 2 Dock High, 3 Grade

•Clear height: 12' – 14'

•Power: 400 amp, 3 phase

•Sprinklers: No

•Zoning: IG2

•Fenced with Truck Drive Through

•Highly desirable close-in Location off Marine Dr close to I-5.

•Level One Available

•Equipment not Included, can be purchased

•Building Sold "AS IS"



Contact: , Martin Stone, CCIM; Sue O'Halloran , CRS

(503) 661-8000

Fax (503) 661-7400

www.kmorealestate.com

Email: Martin@kmorealestate.com; Sue@kmorealestate.com

KMO
KOHLERMAYERS O'HALLORAN, INC.

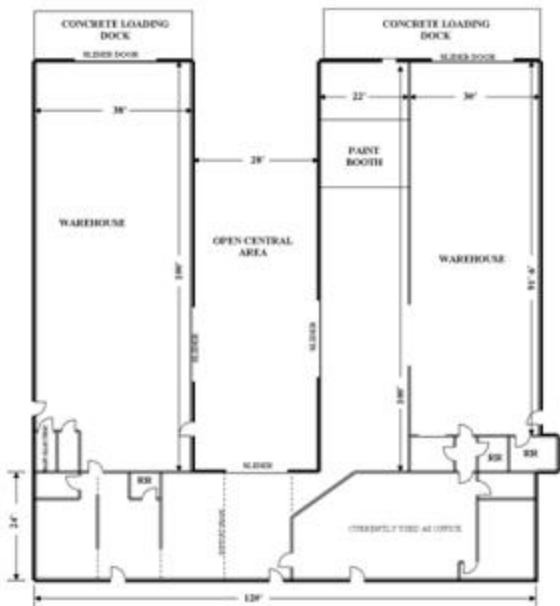

20' GAP BEHIND BYE-GOAT AREA AND 17' ON TOPPED

